

TUSCAN LEVEL RAILING



TUSCAN
MANUFACTURING

INSTALLATION GUIDE

See reverse for illustrations

Vinyl Kits Include:

- 2 Top/Bottom Rails w/aluminum inserts
Balusters (13-6' • 18-8' • 22-10')
- 4 Mounting Brackets
- 8 Mounting Screws w/plugs (#10x2" SS)
- 8 White Head Screws (#10 x 1½" SS)
- 1 Foot Block

Composite Kits Include:

- 2 Top/Bottom Rails
Balusters (13-6' • 18-8')
- 4 Mounting Brackets
- 8 Mounting Screws w/plugs (#10x2" SS)
- 8 White Head Screws (#10 x 1½" SS)
- 1 Foot Block

Step 1 Safety Precautions

Review all local building codes.
Wear proper safety equipment.

Step 2 Prepare Mounting Surfaces

Level all posts or other mounting surfaces. Make certain all surfaces are secure.
Install trim rings and post sleeves.

Step 3 Mark & Cut Railing

Always lay vinyl railing on a non-abrasive flat surface. At the point where railing will mount, measure distance between posts. Mark bottom rail, allowing equal and maximum distance from post to baluster on each end of bottom rail. **DO NOT EXCEED 4" OR GREATER SPACE BETWEEN MOUNTING SURFACE AND BALUSTER.** Vinyl rail and aluminum insert can be cut simultaneously. (Use a medium to high tooth count carbide tip blade.) If post or mounting surface is level, top rail will be the same length as bottom rail. Ensure baluster spacing matches on both rails.

Step 4 Arrange Railing Section

Lay bottom rail on a non-abrasive flat surface. Install foot block by finding center of bottom rail and installing screw through foot block onto rail.

Insert all balusters in routed holes in bottom rail. Set top rail in place, insert balusters at one end and continue to the opposite end until all balusters are inserted.

Wrap two ratchet straps around rail section to hold it together. Slide four mounting brackets on rail ends, ensuring that screw holes are facing towards balusters.

COMPOSITE NOTE: WITH BOTTOM OF RAIL FACING UP, DRILL 2 OR 3 WEEP HOLES (¼") EVENLY SPACED THROUGH BOTTOM AND MIDDLE WALLS OF RAIL TO ALLOW FOR DRAINING OF CONDENSATION BUILD UP. (BOTTOM RAIL ONLY.)

Step 5 Determine Bottom Rail Height

Consulting your local building code, determine the distance between the deck surface and bottom rail. To support the railing section during installation, cut two spacer blocks to fit below bottom rail and place about 3" away from the posts.

Step 6 Install Railing Section

Place railing section on spacer blocks and line up brackets to mounting surface. On each mounting surface, mark and drill two 5/32" holes for bracket mounting screws.

Pull foot block down (do not exceed 3½" height) until it touches deck surface. Align foot block flush with railing and trace around it with a pencil. Remove railing section and make an "X" in the middle of foot block tracing to find center. Pre-drill a 8" hole. Install the foot block base plate with flanges facing up by inserting a screw into the pre-drilled hole.

Place railing section on spacer blocks, resting foot block squarely on base plate. Install screw through side of foot block to lock its height in place.

Install brackets using two 2" mounting screws for each bracket. Apply PVC cement or silicone adhesive to bracket screw holes and cover up holes with plastic screw hole plugs. Install two 1½" white head screws through side of bracket into rail. Remove spacer blocks and ratchet straps.

Step 7 Trim Posts & Install Caps

Trim post sleeves to proper height (2½" - 3½" from top of bracket) and install post caps using PVC cement or silicone adhesive.

TUSCAN LEVEL RAILING



TUSCAN
MANUFACTURING

ILLUSTRATIONS

See reverse for detailed written installation guide

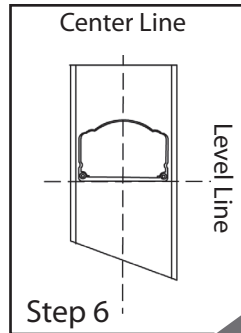
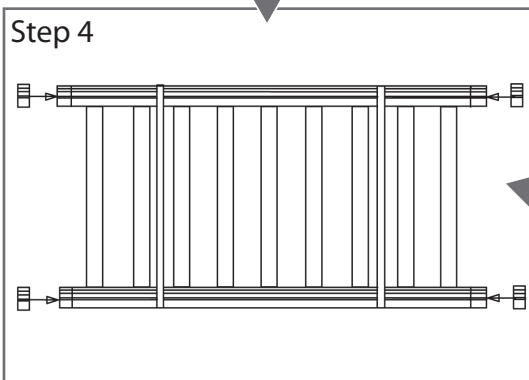
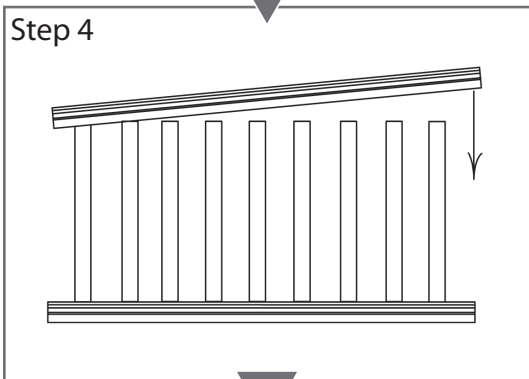
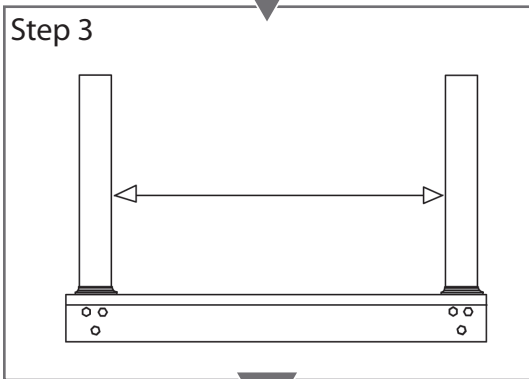
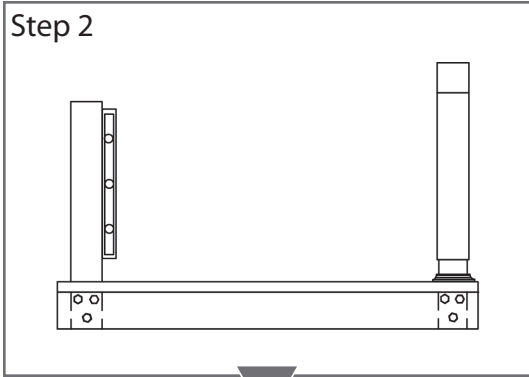

Step 6

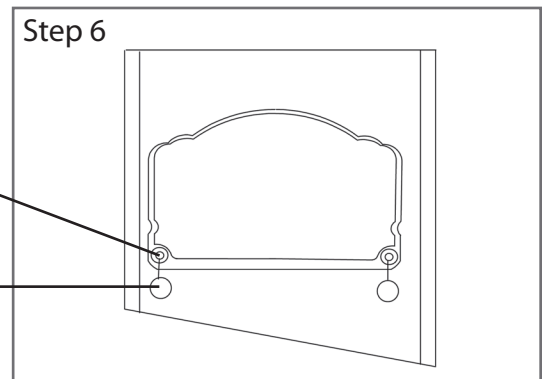
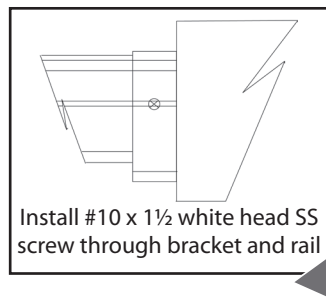
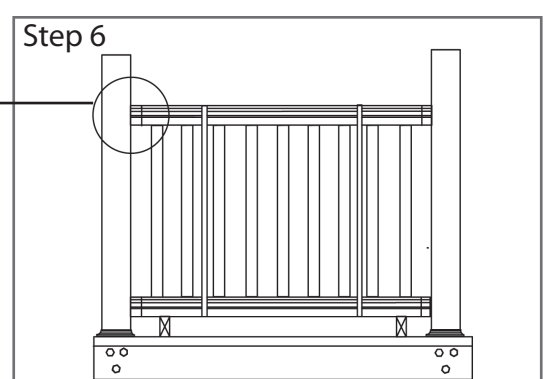
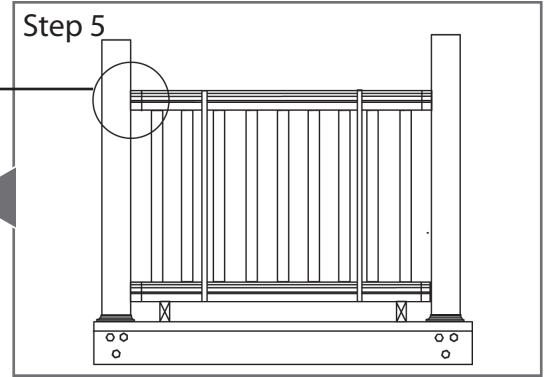

Pre-drill 5/32" hole
and install
two #10 x 2"
SS screws

Install vinyl plugs
over screw heads
using PVC cement